

# Operation Instructions

Make your choice...

## ADC-EB-522-V2 Touchless Capacitive Washroom Switch kits



### 1 Safety Instruction

**!** NOTE: Before changing any settings (especially changing the working status of the electric strike through changing the jumper position), please power off the system, or the instantaneous high voltage and current will burn the electric strike or damage the controller.

### 2 Product Overview

- This product is mainly used for occasions with limited personnel.
- Adopt large metal touchless panel design.
- Inter and outer panels with text, icon indicators. The panel marks clearly.
- This product is provided with two modes: Limited time use auto unlock and unlimited time use.

Such as: Airport, subway station, shopping mall or other places of automatic door.

### 3 Product Overview

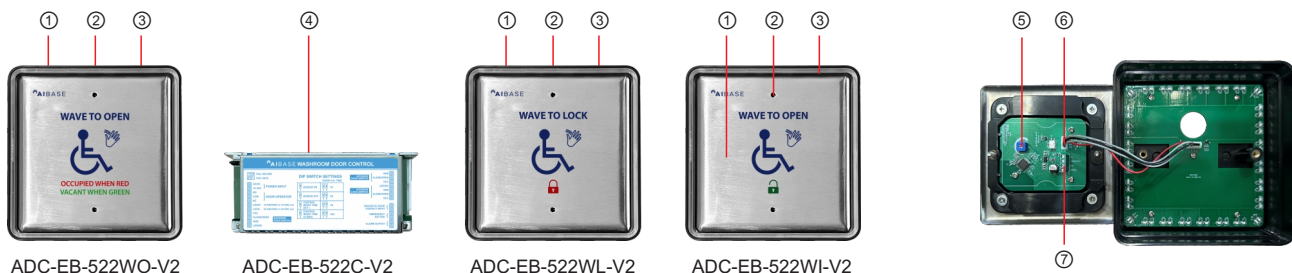

ADC-EB-522WO-V2

ADC-EB-522C-V2

ADC-EB-522WL-V2

ADC-EB-522WI-V2

①Sensing panel    ②Screw holes    ③LED indicator lights    ④Controller

⑤Sensing distance adjustable knob    ⑥LED light connection socket    ⑦Controller connection terminal

### 4 Use Process

#### Before Powering:

Ensure all buttons and controllers are correctly connected before powering the system. Refer to the wiring diagram for more details

#### Initializing:

1. System power on, all devices in learning mode.
2. "Wave to Open" button outside stay on green light.
3. "Wave to Open" button inside and "Wave to Lock" button flashing green light then turn off.
4. Electric strike on the "Unlock" mote.

#### System Workflow:

##### Washroom Vacant:

When the "Wave to Open" button outside lights up green and is triggered, the door will open automatically.

##### Washroom Occupying:

When the door is properly closed, triggering the "Wave to Lock" button inside will lock the electric strike, and the light of the "Wave to Lock" button will turn red. The door will be locked

### Important notice:

#### Note #1

When the door is locked by user inside, the "wave to open" button outside turns red, and the door cannot be opened by triggering the button.

#### Note #2:

If the user triggers the "wave to lock" button when the door is not completely closed (or the door magnet is in a separate state), the door will not lock, and the controller will emit two beeps.

#### Back to Vacant:

Triggering the "Wave to Open" button inside:

1. The "Wave to Open" button inside will flash a green light for 1 second.
2. The electric strike will unlock and open the door.
3. The light of the "Wave to Lock" button inside will turn off.
4. The light of the "Wave to Open" button outside will turn solid green.
5. The system will return to idle state.

#### Emergency Button Instructions:

If users having emergencies inside the washroom, they can press the emergency button.

This will activate the outside emergency light and the siren, and the electric strike will automatically unlock.

## 5 Sensing Distance Setting

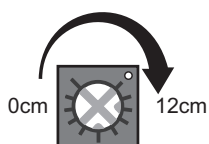

Adjustable sensing distance range: 0-12 cm.  
Clockwise: Increases sensing distance.  
Counterclockwise: Decreases sensing distance.

## 6 DIP Switch Setting

Buzzer setting	1	ON: When it be triggered, there will be a beep voice.			
	1	OFF: When it be triggered, no beep voice.			
Locked time setting	2	The maximum service time is 45mins, it will reset this system after 45mins locking, the door will be unlocked automatically even though not sensing it.			
	2	Unlimited service time, when automatic door locked, it will maintain the locked state until trigger unlock button of the inner panel.			
Relay output time setting	4  3  1S	4  3  5S	4  3  7S	4  3  15S	When sensing and door opens, relay output door opening time can be: 1 seconds, 5 seconds, 7 seconds, 15 seconds.

## 7 Technical parameters

Power supply	AC/DC 12 ~ 30V
Static current	79mA (DC12V power supply)
Action current	220mA (DC12V, not including electric lock)
Sensing mothed	Capacitive sensing technology
Sensing distance	0-12cm (Adjustable)
Panel size	129mm(L)×129mm(W)×47mm(H)
Controller size	143mm(L)×60mm(W)×40mm(H)

## 8 Wiring Diagram

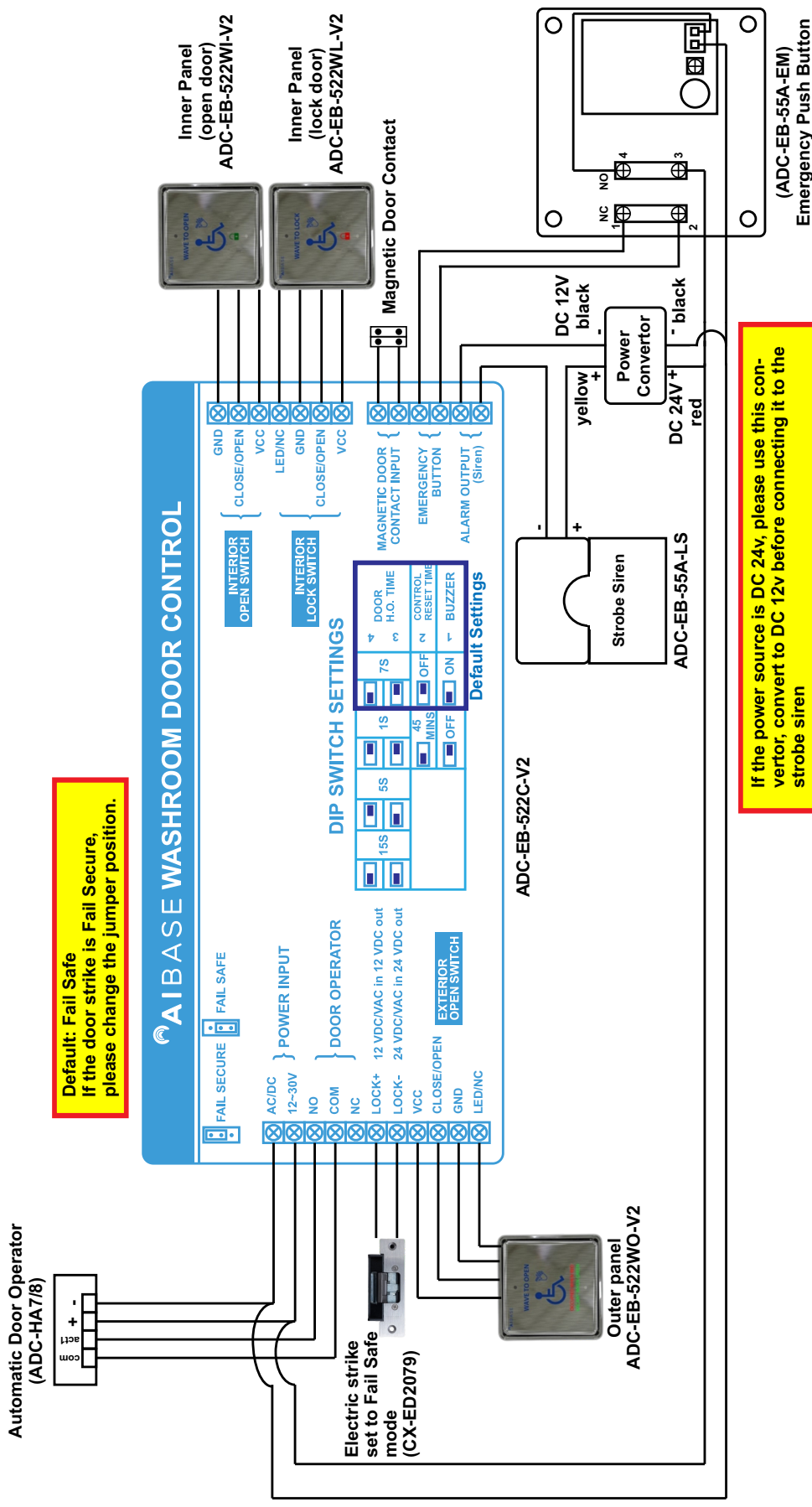

**Default: Fail Safe**  
If the door strike is Fail Secure, please change the jumper position.

**If the power source is DC 24v, please use this converter, convert to DC 12v before connecting it to the strobe siren**

**NOTE:** 1. 12V DC or 24vDC power input for both controller and electric strike.  
2. Magnetic door contact must be connected then the controller and electric strike to be locked.